

## The Ways of connecting to Work Systems from Home

### The 2 ways of connecting

There are two main options when trying to access the PowerNet systems from home, Using Work Hardware (Laptop, Desktop or Thin Client) or using your personal computer to access the Terminal Server Environment.

- **Option 1**

Using a work Laptop or Desktop you can access work resources by first connecting to your home internet (either via WIFI [if on a laptop] or Ethernet cable) once connected you would then be able to connect to the PowerNet VPN.

If you are on a Thin Client all you need to do is connected it to your home internet connection then click on the PNLFARM icon on the desktop and login.

(See Page 2 for Step by Step instructions)

- **Option 2**

Using a personal computer to access the Terminal Server Environment.

This involves having to go to the PowerNet RDWeb page on your personal PC, login in and download the PNLFARM app and then running it.

(See Page 5 for Step by Step Instructions)

## Option 1 Step by Step

### Internet Access

You will need to have connected to an internet connection, via either a cable or Wi-Fi before trying to connect to establish a VPN connection.

You can connect to your Wi-Fi from the logon screen by clicking the network connection icon.

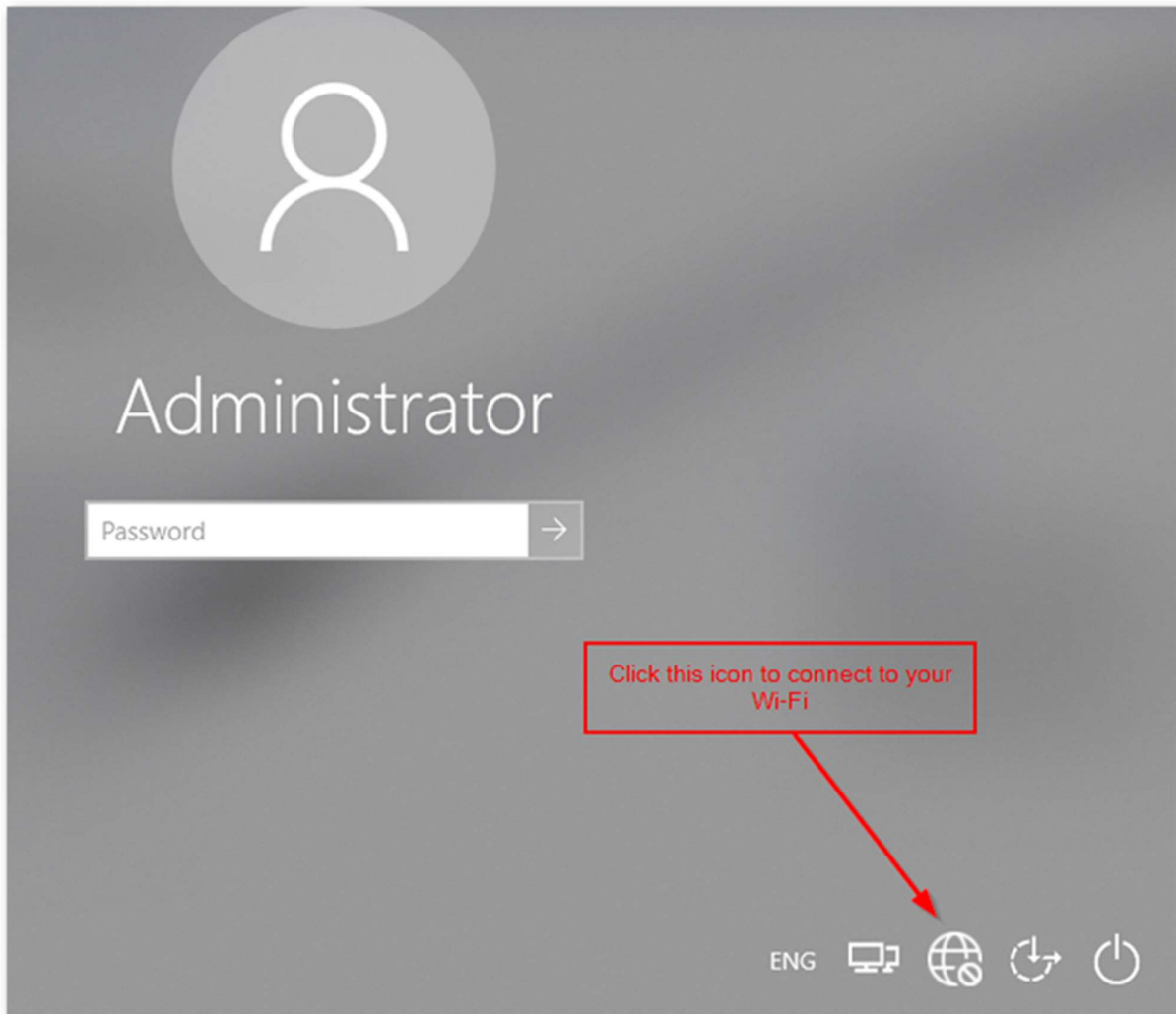

From your home screen, click the icon that looks like two screens.

The logon screen icon will change and you will put in your usual PowerNet username and password.

The computer will establish a VPN connection and log you in one-step.

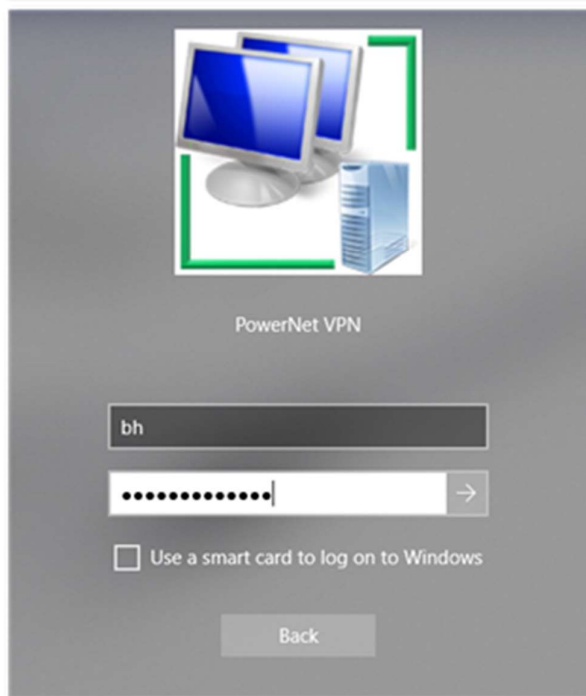
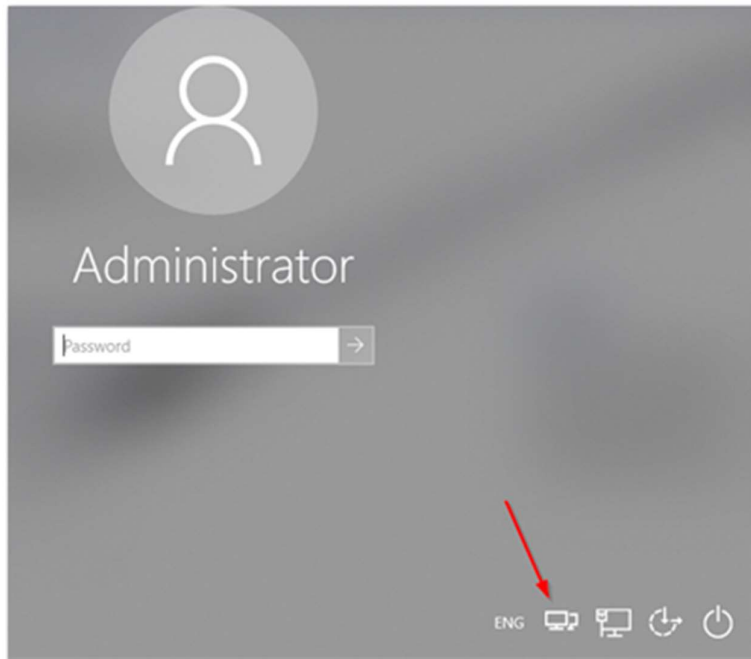

### Alternative if you have already logged in

If you have already logged onto your computer, click the network connections icon, you will see a listing for "PowerNet VPN", select this, and click the "Connect" button.

Your computer will connect to the VPN and the connect button will change to "Disconnect".

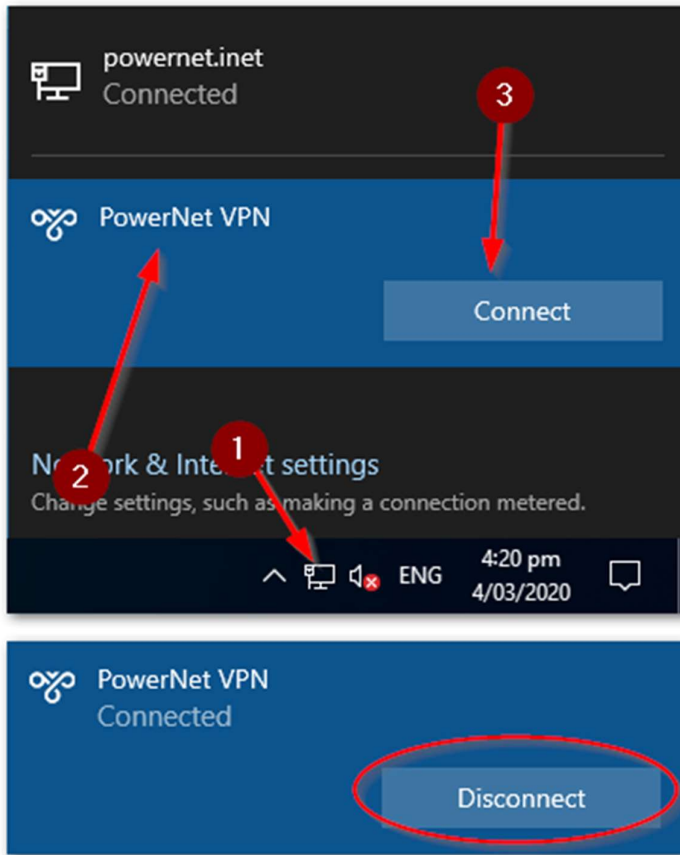

**Disconnecting or shutting your computer down.**

There is no special steps required when you are finished, shut your computer down as you would normally.

## Option 2 Step by Step

Go to <https://rdw.powernet.co.nz>

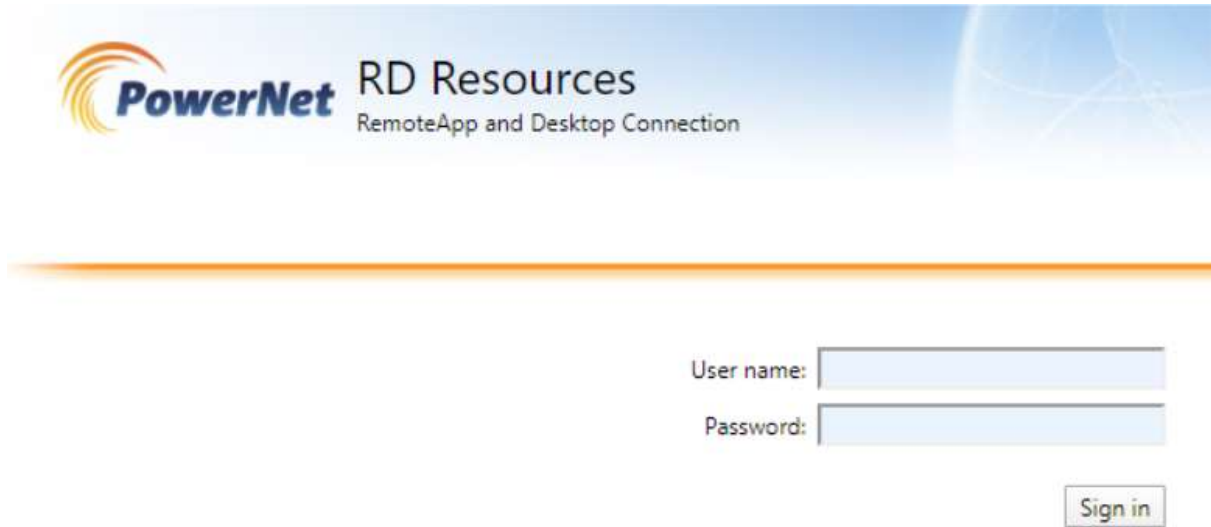

**PowerNet** RD Resources  
RemoteApp and Desktop Connection

User name:

Password:

Using your PowerNet Username and Password to sign in, if you can't sign in Ring I.T

Click on the icon 'PNLFARM" this will download a .RDP file (You may see other icons but the one you need is the one called PNLFARM)

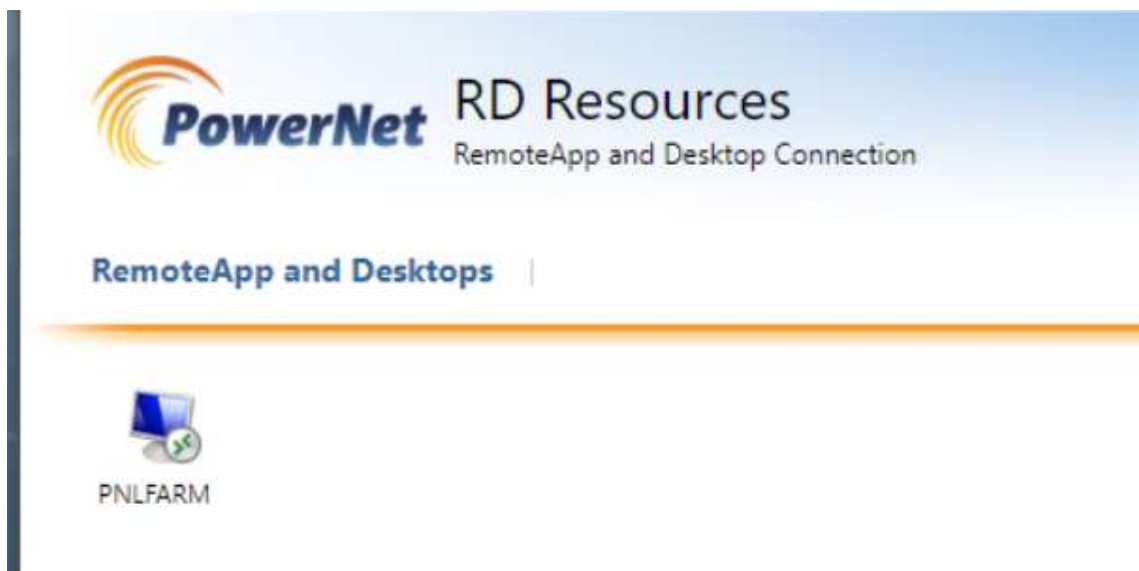

When you click on the file it will download it you will need to click on the download file to run it.

It will ask you for you PowerNet username and password, when putting in your Username put in this format pnI\_domain\ [USERNAME] eg pnI\_domain\ajc

This will now connected you to the PowerNet Terminal Server Environment.